



Vendor: CompTIA

Exam Code: N10-006

Exam Name: CompTIA Network+ Certification Exam

Version: DEMO

-----Added New 20 Lab Simulation -----

QUESTION 1

A network technician has been tasked with connecting three 802.11a clients to an 802.11g access point that is configured for WEP and is within a (9m) line of sight from the client. The clients are unable to associate with the access point. Which of the following is MOST likely the cause of this issue?

- A. Interference
- B. Wrong frequency
- C. Signal loss
- D. Wrong Encryption

Answer: B

Explanation:

802.11a operates in the 5GHz band while 802.11g operates in the 2.4GHz band.

QUESTION 2

Drag and Drop Question

Your company recently purchased a new building down the street from the existing office. For each of the tasks below, select the appropriate antenna type and encryption object for all wireless access point (AP).

1. Create an encrypted wireless connection between the two buildings that BEST controls signal propagation, while maximizing security.
2. Restrict the wireless signal generated by the access points (AP's) inside Building 1, so that it minimizes broadcast beyond the building.
3. Maximize wireless coverage inside Building 1.
4. Building 1's internal wireless network is for visitors only and must not require any special configuration on the visitor's device to connect.

Drag and Drop the correct antenna type and security option to each of the correct Access Points accordingly.

Building 1

Building 2

External AP4

External AP5

AP1

AP2

AP3

Options:

- Open
- WEP
- WPA2-CCMP
- WPA2-TKIP

- 4 dBi Omnidirectional
- 5 dBi Directional Right
- 5 dBi Directional Left
- 14 dBi Parabolic Right
- 14 dBi Parabolic Left

Answer:

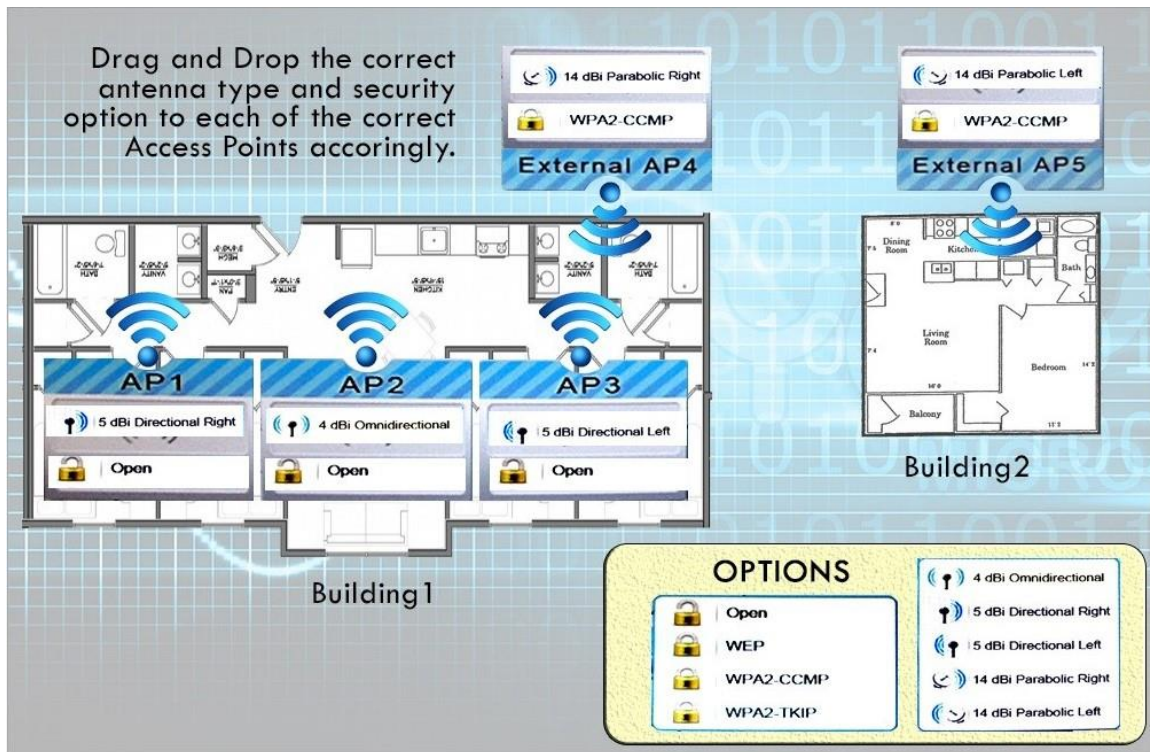

QUESTION 3

Drag and Drop Question
Build a T-658A Connection

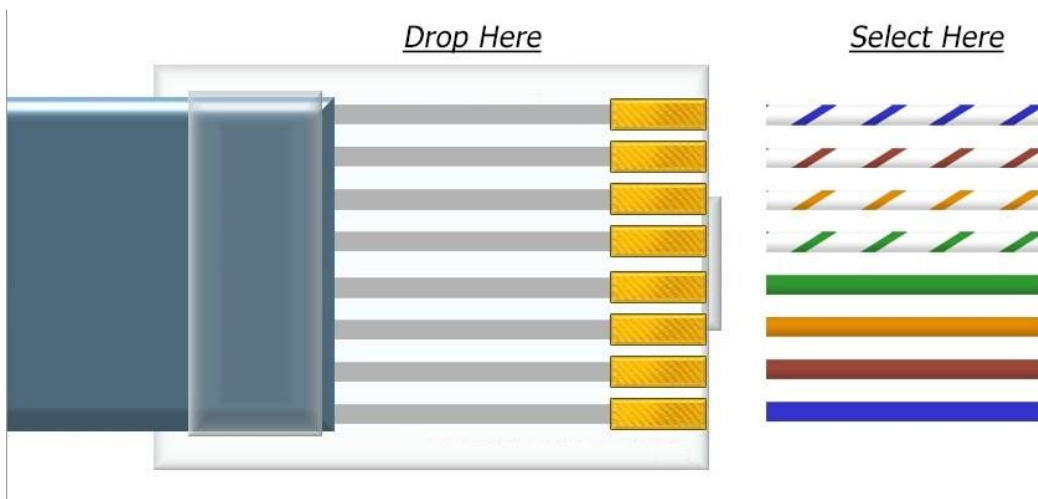

Answer:

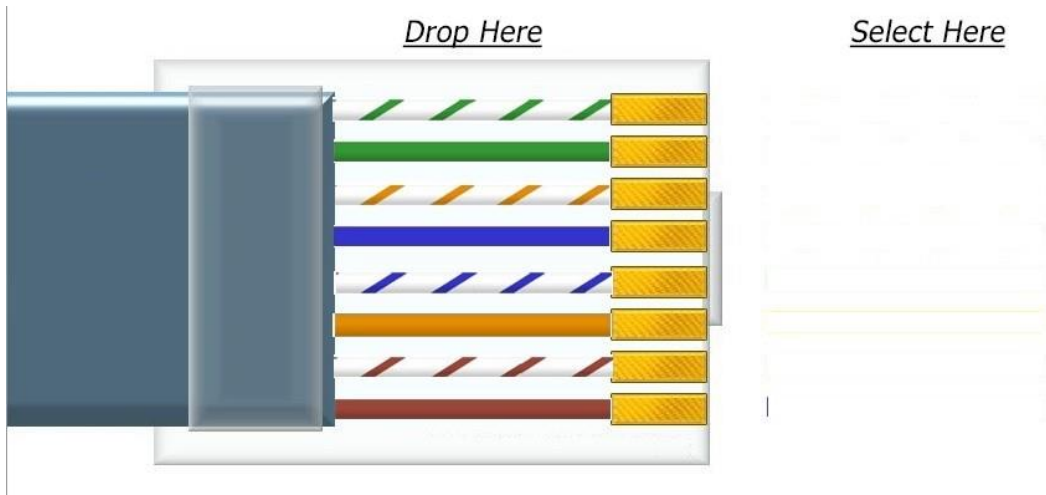

QUESTION 4

A network administrator was told by the Chief Information Officer (CIO) to set up a new office with a network that has redundancy.

Which of the following topologies would the network administrator need to administer?

- A. Hybrid
- B. Bus
- C. Mesh
- D. Partial mesh
- E. Star

Answer: C

QUESTION 5

An engineer is reviewing network logs on a management switch and discovers that, compared to previous reports, a large amount of traffic is coming from a particular node. Upon further investigation, the engineer determines traffic coming from the port in question is using ports that indicate NAT is occurring somewhere downstream from that point. After conferring with another network manager, the team determines a user has added an unauthorized SOHO WLAN router to the network. Among the vulnerabilities that could result from such an action is the possibility of the user inadvertently connecting the LAN interface of the SOHO router into the LAN port coming from the corporate network.

This configuration would MOST likely result in which of the following scenarios?

- A. Excessive interface on the corporate LAN port
- B. DHCP scope exhaustion
- C. Evil twin stacks
- D. Competing DHCP servers on a single LAN

Answer: C

QUESTION 6

An organization wants to improve its ability to detect infiltration of servers in a DMZ, IPS/IDS solutions are currently located on the edge between DMZ and Untrust, and DMZ and Trust. Which of the following can increase visibility inside the DMZ?

- A. Layer 7 firewall
- B. Honeypot
- C. NAC server
- D. Host-based firewalls in the DMZ

Answer: A

Explanation:

[https://en.wikipedia.org/wiki/DMZ_\(computing\)](https://en.wikipedia.org/wiki/DMZ_(computing))

QUESTION 7

A technician receives a report that a user's workstation is experiencing no network connectivity. The technician investigates and notices the patch cable running from the back of the user's VoIP phone is routed directly under the rolling chair and has been smashed flat over time. Which of the following is the most likely cause of this issue?

- A. Cross-talk
- B. Electromagnetic interference
- C. Excessive collisions
- D. Split pairs

Answer: C

QUESTION 8

Which of the following tools would a network technician use to troubleshoot a span of single-mode fiber cable?

- A. Punchdown tool
- B. Spectrum analyzer
- C. Ethernet tester
- D. OTDR

Answer: B

QUESTION 9

A network technician has received reports of an Internet-based application that has stopped functioning. Employees reported that after updating the Internet browsers, the application began to fail. Many users rolled back the update, but this did not correct problem. Which of the following should the company do to reduce this type of action from affecting the network?

- A. Implement a disaster recovery plan with a hot site to allow users to continue working.
- B. Segment the network and create a test lab for all updates before deployment.
- C. Verify the update hashes match those on the vendor's website.
- D. Coordinate the Internet Server update to coincide with the users' updates.

Answer: B

QUESTION 10

A project lead is reviewing the statement of work for an upcoming project that is focused on identifying potential weaknesses in the organization's internal and external network infrastructure. As part of the project, a team of external contractors will attempt to employ various attacks against the organization. The statement of work specifically addresses the utilization of an automated tool to probe network resources in an attempt to develop logical diagrams indication weaknesses in the infrastructure.

The scope of activity as described in the statement of work is an example of:

- A. session hijacking
- B. vulnerability scanning
- C. social engineering
- D. penetration testing
- E. friendly DoS

Answer: D

QUESTION 11

A network technician is selection the best way to protect a branch office from as many different threat from the Internet as possible using a single device.

Which of the following actions would meet the objective?

- A. Configure a network-based firewall.
- B. Configure a firewall with UTM.
- C. Configure a host-based firewall.

Answer: A

QUESTION 12

A network technician has been tasked to provide a local office with wireless Internet access.

The network technician had determined the users will need a wireless router that provides a maximum of 54Mbps of bandwidth while operating in the 2.4Ghz band.

Which of the following wireless standards will the network technician deploy?

- A. 802.11a
- B. 802.11b
- C. 802.11g
- D. 802.11n

Answer: C

Explanation:

802.11g provides transmission over short distances at up to 54Mbps in the 2.4GHz bands.

Incorrect Answers:

A: 802.11a provides transmission at up to 54Mbps but it operates in the 5GHz band.

B: 802.11b operates in the 2.4GHz band but only provides transmission at up to 11Mbps.

D: 802.11n operates in the 2.4GHz band but uses spatial multiplexing to provide transmission in excess of 54Mbps.

QUESTION 13

A technician is looking at an issue with a computer connecting to the network. The technician determines wire 3 of a UTP Ethernet cable run has a break in it. This computer was previously connected to the switch at 1Gbps throughput. This PC is a kiosk and does not need anything more than 50-60Mbps connection speed.

Which of the following can the technician do to resolve the issue quickly?

- A. Rewire both ends to have the wire on pin 6 remapped to pin 3.
Force the duplex and speed to 100Mbps full duplex.
- B. Rewire both ends to have the wire on pin 6 remapped to pin 3.
Force the duplex and speed to 1000Mbps full duplex.
- C. Rewire both ends to have the wire on pin 7 remapped to pin 3.
Force the duplex and speed to 100Mbps full duplex.
- D. Rewire both ends to have the wire on pin 7 remapped to pin 3.
Force the duplex and speed to 1000Mbps full duplex.

Answer: D

Explanation:

http://pinouts.ru/NetworkCables/ethernet_10_100_1000_pinout.shtml

QUESTION 14

Which of the following physical devices provides the BEST security to a datacenter?

- A. Cipher lock
- B. Thumbprint reader
- C. Video monitoring
- D. Mantrap
- E. Key pad

Answer: D

QUESTION 15

A network administrator need to install a border device on the network that will help ensure FTP commands are not being sent in traffic communicating on port 25.

Which of the following devices will allow for deep packet inspection?

- A. Layer 7 firewall
- B. Web proxy
- C. Layer 3 switch
- D. Protocol analyzer

Answer: B

Explanation:

http://www.infosectoday.com/Articles/Deep_Packet_Inspection_Technologies.htm

Thank You for Trying Our Product

Lead2pass Certification Exam Features:

- ★ More than **99,900** Satisfied Customers Worldwide.
- ★ Average **99.9%** Success Rate.
- ★ **Free Update** to match latest and real exam scenarios.
- ★ **Instant Download** Access! No Setup required.
- ★ Questions & Answers are downloadable in **PDF** format and **VCE** test engine format.
- ★ Multi-Platform capabilities - **Windows, Laptop, Mac, Android, iPhone, iPod, iPad**.
- ★ **100%** Guaranteed Success or **100%** Money Back Guarantee.
- ★ **Fast**, helpful support **24x7**.



View list of all certification exams: <http://www.lead2pass.com/all-products.html>



Microsoft



ORACLE



CITRIX



JUNIPER
NETWORKS



EMC²
where information lives®

10% Discount Coupon Code: ASTR14